

THE INFORMATION ON THIS DRAWING IS TO THE ORDNANCE SURVEY IRELAND ITM COORDINATE SYSTEM

- LEGEND:**
- Site Boundary
 - - - Proposed Foul Sewer & Manhole
 - - - Proposed Storm Sewer & Manhole
 - - - Proposed Overflow Sewer & Manhole
 - - - 100 Ø HDPE RAISING MAIN
 - ▲ Proposed Thrust Blocks
 - - - Existing Foul Sewer
 - Existing Rising Main
 - - - Developable Area
 - ▨ Bioswale

- NOTES:**
1. FIGURED DIMENSIONS ONLY TO BE TAKEN FROM THIS DRAWING.
 2. ALL DRAWINGS TO BE CHECKED BY THE CONTRACTOR ON SITE.
 3. ENGINEER/EMPLOYERS REPRESENTATIVE, AS APPROPRIATE, TO BE INFORMED BY THE CONTRACTOR OF ANY DISCREPANCIES BEFORE ANY WORK COMMENCES.
 4. THE CONTRACTOR SHALL UNDERTAKE A THOROUGH CHECK FOR THE ACTUAL LOCATION OF ALL SERVICES/UTILITIES, ABOVE AND BELOW GROUND, BEFORE ANY WORK COMMENCES.
 5. ALL LEVELS SHOWN RELATE TO ORDNANCE SURVEY DATUM AT MALIN HEAD.

Rev	Date	Description	By	Chkd.
P01	08.07.2022	Issued For Planning	MN	BH

Client: Glennveagh Homes

Project: Residential Development, Ennis, Co. Clare.

Title: Proposed Drainage Layout Sheet 4 of 4

Scale @ A1: 1:500 / @A3 1:1000

Prepared by: MN Checked: BH Date: July 2022

Project Director: Brian Carroll

Drawing Status: Planning

TOBIN
CONSULTING ENGINEERS

Galway Office
Fairgreen House, Fairgreen Road,
Galway,
H91 AXK8,
Ireland.

Tel: +353 (0)91 565 211
www.tobin.ie

Drawing No: 11269-2104 P01

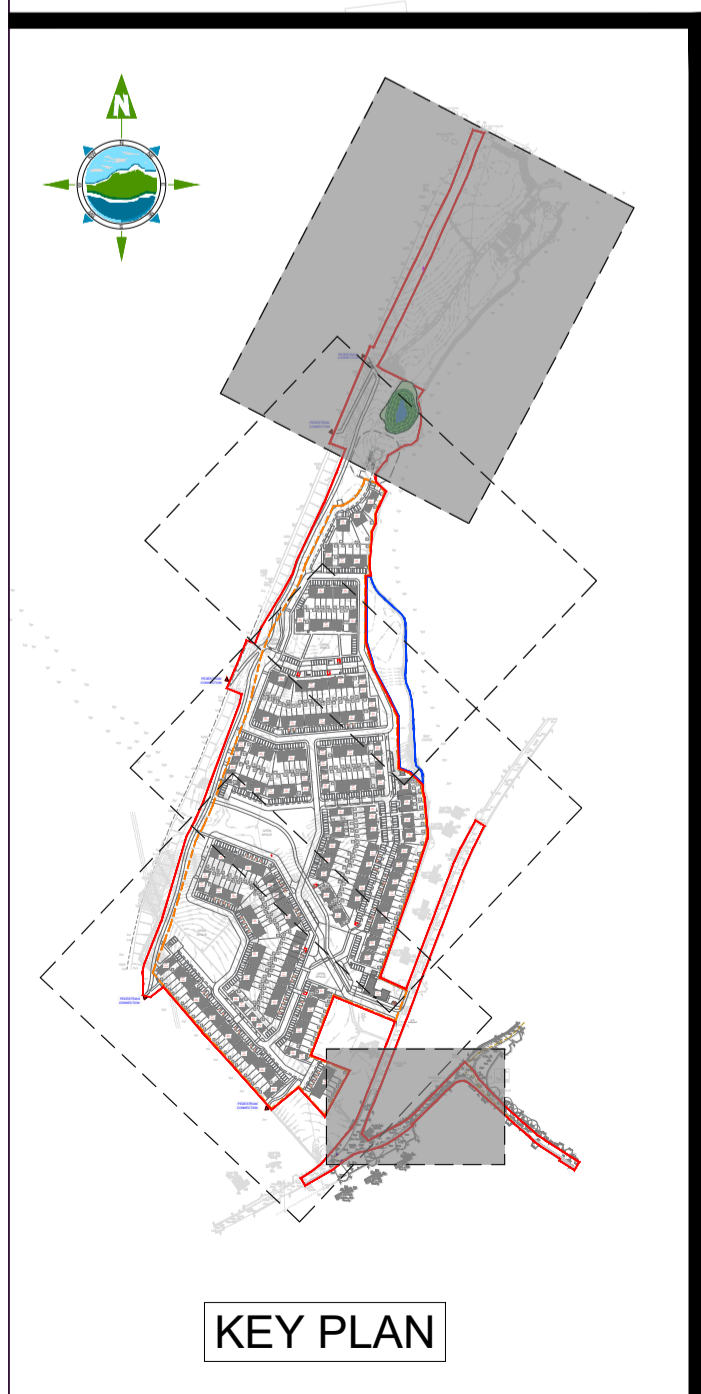

NOTES:

ALL WORKS WILL BE DESIGNED AND CONSTRUCTED IN ACCORDANCE WITH THE IRISH WATER (IW) CODE OF PRACTICE (COP) FOR WASTEWATER INFRASTRUCTURE IW-CDS-5030-03 AND IRISH WATER STANDARD DETAILS IW-CDS-5030-01.

THE CONTRACTOR SHALL ENSURE IRISH WATER CONNECTION DETAILS ARE ADHERED TO. REFER TO STANDARD DETAILS AVAILABLE FROM <https://www.water.ie/connections/developer-services/>

INDIVIDUAL WASTEWATER SERVICE CONNECTIONS TO EACH DWELLING ARE SHOWN INDICATIVELY. FINAL DESIGN WILL BE CONFIRMED WITH M&E DESIGNER AND SHALL BE AS PER STANDARD DETAILS STD-WW-02, STD-WW-03, STD-WW-04 AND STD-WW-05 & 05A.

INDIVIDUAL STORM SEWER CONNECTIONS TO EACH DWELLING ARE SHOWN INDICATIVELY. FINAL LOCATIONS TO BE CONFIRMED WITH M&E DESIGNER.

AS PER THE BUILDING REGULATIONS TECHNICAL GUIDANCE DOCUMENT - PART H AND IRISH WATER CODE OF PRACTICE, FOUL SERVICE CONNECTIONS TO BE LAID AT MINIMUM 1:40 WHERE NO WC IS CONNECTED AND MINIMUM 1:60 ONCE WC HAS BEEN PICKED UP. CONTRACTOR TO WORK WITHIN ABOVE GRADIENT LIMITS WHILE ENSURING THE REQUIRED SEPARATION DISTANCES ARE ACHIEVED.

ALL STORM SERVICE CONNECTIONS TO BE LAID AT MINIMUM 1:80 GRADE.

INSPECTION CHAMBERS SHALL BE IN COMPLIANCE WITH STANDARD DETAILS STD-WW-03 AND STD-WW-13 AND WILL BE LOCATED WITHIN 1.0m OF EACH PROPERTY BOUNDARY.

GRAVITY SEWER PIPE MATERIALS USED SHALL BE IN COMPLIANCE WITH SECTION 3.13 OF THE CODE OF PRACTICE. UNPLASTICISED PVC PIPES AND FITTINGS SHALL BE OF STIFFNESS CLASS OF 8kN/m2.

PIPE MATERIALS WILL BE UNPLASTICISED PVC (WAVSPEC SN8 OR SIMILAR) FOR

THE MAIN SEWERS AS PER SECTION 3.13.3 OF THE CODE OF PRACTICE.

MANHOLES ARE REQUIRED TO CONFORM TO STANDARD DETAILS STD-WW-09, STD-WW-10, STD-WW-11 AND/OR STD-WW-12 AS APPROPRIATE.

SEPARATION DISTANCES OF FOUL SEWERS TO STRUCTURES AND OTHER UTILITIES WILL COMPLY WITH SECTION 3.5 OF THE CODE OF PRACTICE.

REFER TO SECTIONS 3.5.16, 3.5.17 AND 3.5.18 OF THE WASTEWATER CODE OF PRACTICE FOR UNAVOIDABLE SERVICE CROSSINGS.

REFER TO STANDARD DETAILS STD-WW-06, STD-WW-06A AND STD-W-12A AND SECTION 3.21 OF THE CODE OF PRACTICE FOR PLANTING RESTRICTIONS TO WATER AND WASTE WATER INFRASTRUCTURE. IF REQUIRED, ROOT PROTECTION TO BE ReRoot 2000 OR SIMILAR.

MANHOLE COVERS SHALL BE SET IN POSITION FLUSH WITH FINISHED GROUND SURFACE, WHETHER ROAD, PAVEMENT OR OPEN GROUND.

REFER TO SECTION 3.5.14 OF THE IW COP FOR GUIDANCE ON STAGGERING OF FOUL AND STORM MANHOLES.

ALL STORM SEWER AND FOUL SEWER PIPES TO BE LAID WITH MINIMUM 1200mm COVER TO CROWN OF PIPES IN ROADS AND DRIVEWAYS AND MINIMUM 900mm COVER IN OPEN SPACES & FOOTPATHS NOT ADJACENT TO CARRIAGEWAYS. WHERE IT IS NOT POSSIBLE TO ACHIEVE THESE MINIMUM COVER DEPTHS, PIPES SHALL BE BEDDED AND ENCASED IN CONCRETE 150mm THICK.

AS PER SECTION 3.5.16 OF THE CODE OF PRACTICE, EXTERNAL FACE OF PROPOSED MANHOLE TO BE MINIMUM 0.5m FROM KERB LINE AND EXTERNAL FACE OF SEWERS TO BE A MINIMUM OF 1.0m FROM KERB LINE.

ALL DOMESTIC SEWER CONNECTIONS SHOWN INDICATIVELY

ALL WORKS TO CARRIED OUT IN ACCORDANCE WITH IRISH WATER CODES OF PRACTICE AND IRISH WATER DETAILS